

vtech[®]
baby

Instruction Manual

Lullaby Sheep Cot Light



VTech understands that a child's needs and abilities change as they grow and with that in mind we develop our toys to teach and entertain at just the right level...

vtech Baby

Toys that will stimulate their interest in different textures, sounds and colours

I am...

...responding to colours, sounds and textures

...understanding cause and effect

...learning to touch, reach, grasp, sit-up, crawl and toddle

Birth-36 months



Pre-School

Interactive toys to develop their imagination and encourage language development

I want...

...to get ready for school by starting to learn the alphabet and counting

...my learning to be as fun, easy and exciting as can be

...to show my creativity with drawing and music so my whole brain develops

3-6 years



Electronic Learning Computers

Cool, aspirational and inspiring computers for curriculum related learning

I need...

...challenging activities that can keep pace with my growing mind

...intelligent technology that adapts to my level of learning

...National Curriculum based content to support what I'm learning at school

4-10 years



To learn more about this and other VTech® products, visit www.vtech.co.uk

INTRODUCTION

Thank you for purchasing the **VTech® Lullaby Sheep Cot Light!** Press the **Lullaby Sheep Cot Light's** sheep button to play soothing responses that calm your little one. Responses include 3 sing-along lullabies, 40 calming melodies, relaxing nature sounds and soothing shushing sounds. Choose between the 2 modes to play either music or sounds.

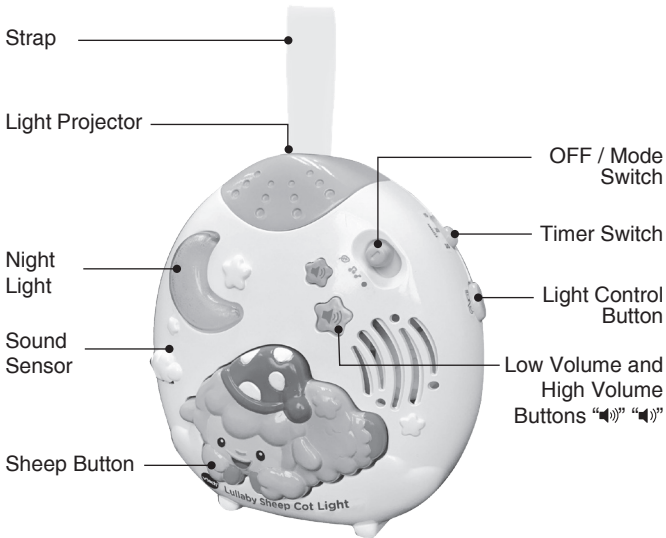

INCLUDED IN THIS PACKAGE

- One VTech® Lullaby Sheep Cot Light
- One attachment strap
- One Quick Start Guide

WARNING:

All packing materials such as tape, plastic sheets, packaging locks, removable tags, cable ties, cords and packaging screws are not part of this toy and should be discarded for your child's safety.

NOTE:

Please save this Instruction Manual as it contains important information.

Warning!

Attach this toy out of the reach of the child. To prevent possible injury by entanglement, remove this toy when the child starts trying to get up on its hands and knees in a crawling position.

Removing the Packaging Locks:

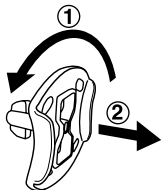

- ① Rotate the packaging locks 90 degrees anticlockwise.
- ② Pull out the packaging locks and discard.

GETTING STARTED

BATTERY REMOVAL AND INSTALLATION

1. Make sure the unit is turned **OFF**.
2. Locate the battery cover on the back of the sheep. Use a screwdriver to loosen the screw.
3. If used batteries are present, remove these batteries from the unit by pulling up on one end of each battery.
4. Install 3 new AA (LR6/AM-3) batteries following the diagram inside the battery box. (The use of new alkaline batteries is recommended for maximum performance).
5. Replace the battery cover and tighten the screw to secure it.

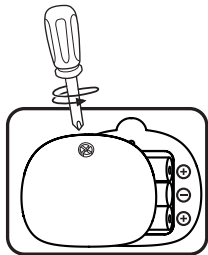

WARNING:

Adult assembly required for battery installation.
Keep batteries out of reach of children.

IMPORTANT: BATTERY INFORMATION

- Insert batteries with the correct polarity (+ and -).
- Do not mix old and new batteries.
- Do not mix alkaline, standard (carbon-zinc) or rechargeable batteries.
- Only batteries of the same or equivalent type as recommended are to be used.
- Do not short-circuit the supply terminals.
- Remove batteries during long periods of non-use.
- Remove exhausted batteries from the toy.
- Dispose of batteries safely. Do not dispose of batteries in fire.

RECHARGEABLE BATTERIES

- Remove rechargeable batteries (if removable) from toy before charging.
- Rechargeable batteries are only to be charged under adult supervision.
- Do not charge non-rechargeable batteries.

Disposal of batteries and product



The crossed-out wheellie bin symbols on products and batteries, or on their respective packaging, indicates they must not be disposed of in domestic waste as they contain substances that can be damaging to the environment and human health.



The chemical symbols Hg, Cd or Pb, where marked, indicate that the battery contains more than the specified value of mercury (Hg), cadmium (Cd) or lead (Pb) set out in the Batteries and Accumulators Regulation.

The solid bar indicates that the product was placed on the market after 13th August, 2005.

 Please dispose of your product and batteries responsibly.

In the UK, give this toy a second life by disposing of it at a small electricals collection point* so all of its materials can be recycled.

Learn more at:

www.vtech.co.uk/recycle

www.vtech.com.au/sustainability

* Visit www.recyclenow.com to see a list of collection points near you.

NOTE:

- Always attach all provided fasteners (strings, straps, clamps, etc.) tightly to a cot or playpen according to the instructions. Check frequently. Attach only to cots with sturdy rails and spindles. Do not attach to play pens with mesh walls.
- Do not add additional strings or straps to attach to a cot or playpen.
- To ensure your child's safety, the product should be assembled by an adult.
- When removing the Cot Light from the cot, please detach the cot attachment straps from the unit, and keep the straps out of your child's reach.

ASSEMBLY INSTRUCTIONS

With the **VTech® Lullaby Sheep Cot Light**, safety comes first. To ensure your child's safety, adult assembly is required.

1. Place the unit in the cot bringing the strap over the top rail. Slip the top of the strap under the slot on the back

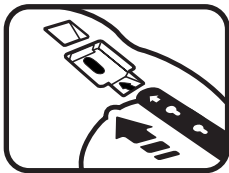

- Place the unit in the cot bringing the strap over the top rail. Slip the top of the strap under the slot on the back of the strap and secure. You can adjust the hanging height by choosing the appropriate hole on the top of the strap.

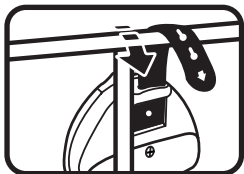

- Pull slightly on the unit to make sure the strap has been securely fastened. The unit should be snug against the cot rail. Please check the unit frequently to ensure it is still secure.

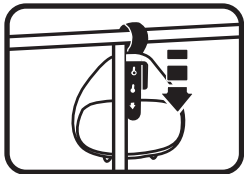

This product is in try-me mode in the packaging. After opening the package, turn the unit off and on again to proceed with normal play. If the unit repeatedly powers down quickly we suggest changing the batteries.

PRODUCT FEATURES

1. Off/Mode Switch

To turn the unit **ON**, slide the **OFF / Mode Switch** to select either **Lullaby Mode** (🎵) or **Sound Mode** (🔊). To turn the unit **OFF**, slide the **OFF / Mode Switch** to the **OFF** (●) position.



2. Volume Controls

To adjust the volume, press the **Low Volume button** (🔊) or the **High Volume button** (🔊🔊🔊).



3. Timer Switch

Slide the **Timer Switch** to select the desired shut off time. Once the set time is up, the unit will enter sleep mode. Time options include 10, 20 or 30 minutes.

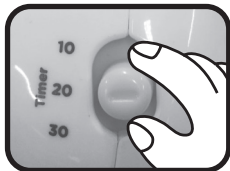

4. Light Control Button

Press the **Light Control Button** to choose between the night light and the light projection.



5. Sheep Button

Press the **Sheep Button** to play the next sound, melody or sing-along song depending on the selected mode.



6. Night Light

If the Night Light is turned **ON** and the Light Projector is turned **OFF**, the Night Light will stay turned **ON** for approximately 30 minutes after the set time is up.

7. Sound Sensor

The **VTech® Lullaby Sheep Cot Light** is equipped with a special **Sound Sensor**. Once the set time is up, the unit will automatically shut off. The sensor will reactivate the program when it detects baby's cry for approximately 2 seconds without interruption. The unit will reactivate and play lullabies or nature sounds depending on the selected mode.

8. Automatic Shut Off

To preserve battery life, the **VTech® Lullaby Sheep Cot Light** will automatically shut off after the timer has expired. The unit can be reactivated by pressing any button, sliding the mode switch or timer switch, or when baby cries.

NOTE: If the unit powers down while playing, we suggest changing the batteries.

ACTIVITIES

1. To turn the unit **ON**, slide the **OFF / Mode Switch** to select either **Lullaby Mode** (🎵) or **Sound Mode** (👂). You will hear sing-along songs and soothing melodies in Lullaby Mode, or soothing sounds in Sound Mode. The projector will light up and the night light will shine.
2. Press the **Sheep Button** to play the next sound, melody or sing-along song depending on the selected mode.

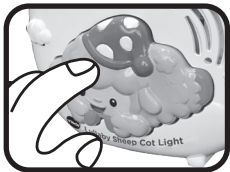

MELODY LIST

1. Ave Maria - Schubert
2. The Blue Danube - Strauss
3. Beautiful Dreamer
4. Cradle Song - Mozart
5. Clair de lune - Debussy
6. Canon in D - Pachelbel
7. Minuet in G Major - Beethoven
8. Berceuse Op. 57 - Chopin
9. String Quintet in E Major Op. 11, No. 5 - Boccherini
10. Moonlight Sonata - Beethoven
11. Swan Lake - Tchaikovsky
12. Nocturnes, Op. 9, No. 2 - Chopin
13. Kinderszenen - Schumann
14. Brahms' Lullaby
15. Ode to Joy
16. Turkish March - Mozart
17. Piano Sonata No. 16 - Mozart
18. Serenade for Strings Op. 3 No. 5 - Haydn
19. Fur Elise - Beethoven
20. Cello Suite No. 1 in G Major - Bach
21. All Through the Night
22. Baa, Baa, Black Sheep
23. Did You Ever See a Lassie?
24. Swing Low, Sweet Chariot
25. Hush, Little Baby
26. Goodnight, Ladies
27. London Bridge
28. Are You Sleeping? (Frère Jacques)
29. Clementine
30. Danny Boy

31. My Bonnie Lies Over the Ocean
32. Do Your Ears Hang Low
33. My Wild Irish Rose
34. Bicycle Built for Two
35. Ride a Cock Horse to Banbury Cross
36. Rock-a-bye Baby
37. Sleep, Baby, Sleep
38. An Irish Lullaby
39. Take Me Out to the Ball Game
40. Oh When the Saints Go Marching In

SING-ALONG SONG LYRICS

SONG 1

Are you sleeping, Are you sleeping?
Brother John? Brother John?
Morning bells are ringing, morning bells are ringing.
Ding, ding, dong. Ding, ding, dong.

SONG 2

Twinkle, twinkle, little star.
How I wonder what you are.
Up above the world so high,
like a diamond in the sky.
Twinkle, twinkle, little star.
How I wonder what you are.

SONG 3

Stars in the sky, peaceful moonlight,
Yawn *Yawn* sleep tight, goodnight.

CARE & MAINTENANCE

1. Keep the unit clean by wiping it with a slightly damp cloth.
2. Keep the unit out of direct sunlight and away from any direct heat source.
3. Remove the batteries when the unit will not be in use for an extended period of time.
4. Do not drop the unit on hard surfaces and do not expose the unit to moisture or water.

TROUBLESHOOTING

If for some reason the program/activity stops working or malfunctions, please follow these steps:

1. Please turn the unit **OFF**.
2. Interrupt the power supply by removing the batteries.
3. Let the unit stand for a few minutes, then replace the batteries.
4. Turn the unit **ON**. The unit should now be ready to play with again.
5. If the product still does not work, install a brand new set of batteries. If the problem persists, please contact our Consumer Services Department and a service representative will be happy to help you.

CONSUMER SERVICES

Creating and developing **VTech®** products is accompanied by a responsibility that we at **VTech®** take very seriously. We make every effort to ensure the accuracy of the information, which forms the value of our products. However, errors sometimes can occur. It is important for you to know that we stand behind our products and encourage you to call our Consumer Services Department with any problems and/or suggestions that you might have. A service representative will be happy to help you.

UK Customers:

Phone: 0330 678 0149 (from UK) or +44 330 678 0149 (outside UK)
Website: www.vtech.co.uk/support

Australian Customers:

Phone: 1800 862 155
Website: support.vtech.com.au

NZ Customers:

Phone: 0800 400 785
Website: support.vtech.com.au

PRODUCT WARRANTY/ CONSUMER GUARANTEES

UK Customers:

Read our complete warranty policy online at vtech.co.uk/warranty.

Australian Customers:

**VTECH ELECTRONICS (AUSTRALIA) PTY LIMITED –
CONSUMER GUARANTEES**

Under the Australian Consumer Law, a number of consumer guarantees apply to goods and services supplied by VTech Electronics (Australia) Pty Limited. Please refer to vtech.com.au/consumerguarantees for further information.

**Visit our website for more
information about our products,
downloads, resources and more.**

www.vtech.co.uk
www.vtech.com.au

